

MODERN LUXURY

BY THE PUBLISHERS OF MIAMI MAGAZINE

Interiors

South Florida

HUMAN TOUCH

VISIONS & VISIONARIES

THE BEST OF
DESIGN MIAMI/
DAVID DE LA GARZA'S
TRUE MATERIALS

PLUS
YVES BÉHAR, MICHELE BÖNAN,
ERIC CHANG & MATT BERMAN



CURVES AHEAD The great room features gray leather sofas and armchairs by Flexform, while Kravet window treatments deliver drama. Opposite page: David De La Garza designed the circular staircase to the rooftop deck to evoke the lookout of a luxury liner.

SOUTH BEACH

FAST COMPANY

A client's third home would not be a typical beach house—instead, it pays tribute to dark sophistication and modern movement.

By Drew Limsky

Photography by Brett Hufziger and Durston Saylor

Interiors by David De La Garza/Zurdo DGS





LIGHT AND DARK

From top: The sitting area of the master bedroom features the leather Bug armchair by Poliform accented with custom-made silver fox pillows; objets de art atop a Ralph Lauren tray and coffee table by Cattelan Italia, in front of a gray Parmount sofa by Luigi Frighetto. Opposite page: The sundeck boasts outdoor furniture by Kettal atop faux grass and loose stone borders.

When Monterrey, Mexico-based architect and designer David De La Garza first visited the installation site, in a soaring tower in the South of Fifth neighborhood, he made a single sketch. De La Garza had been friends with his Mexican-based client for a long time, and there was a certain comfort level as the architect roughed out a workable plan. Over the next two years, everything about this formidable and unexpected project derived from that sketch.

The project became De La Garza's fourth installation in Miami. What his client wanted—or rather, what he didn't want—for his 5,000-square-foot home became clear at the outset. Despite the fact that he would be spending perhaps four days a month in the tony two-story penthouse (actually three stories, counting the 400-square-foot roof deck), the man was decisive.

This client with a handful of grown children already owned two homes—and one was a vacation home on South Padre Island, Texas that already communicated the typical beach house aesthetic. "It was all white linen, that laid-back beach feeling," De La Garza says. "But for this project he wanted more than that, more than the Miami all-white modern beach house."

The designer says his first suggestion, in order not to compete with the views, was to select from a darker palette. "It's a big project, so we didn't need light colors to make it appear larger," he recalls. "That's why we went with grays and darker hues, aluminum and stainless steel. The result was Manhattan meets Miami." The Ornare kitchen is a case in point. "I was happy to work with Claudio Faria," the designer says, "and





I told him, 'I want to enter the kitchen and see the reflection of the sea—I want the kitchen to almost feel invisible.' So that's why we used the black color and the glass."

As Faria recalls, "David used Ornare's Satyrium line, which presents a flush, continuous look with no handles. He chose black lacquer and glass for a sophisticated and dramatic look." De La Garza created an egg-shaped island from granite, oak and corian to complement the Ornare cabinetry.

Anchoring the residence is a double-height great room in white and gray that emphasizes vertical and horizontal lines. De La Garza called on Thomas Paterson, the director and founder of Lux Populi, based in Mexico City, to execute the minimalist lighting; along with subtle LEDs, stainless steel and glass pendants fall from the ceiling, like droplets in an S form. An elegant column of gray limestone echoes the gray Kravet window treatments, which fall two stories. These choices hardly suggest a casual beach house—the look is far more evocative of Miami Beach's glamorous midcentury heyday. "I chose those curtains to honor the golden age of the Fontainebleau Hotel," De La Garza says. The Flexform leather sofas read like clean slabs of gray, a horizontal counterpoint to all the verticals.

The showstopping cantilevered staircase that leads to the second floor is a bracing reminder of the project's considerable ambitions. De

FLIGHTS OF FANCY

From top: In the master bedroom, the Minotti bed rests against a zebra wood bed wall. The reflective art piece is actually the fuselage from a DC-9. Opposite page: The kitchen features cabinetry from Ornare's Satyrium line and an egg-shaped island custom-made by De La Garza.

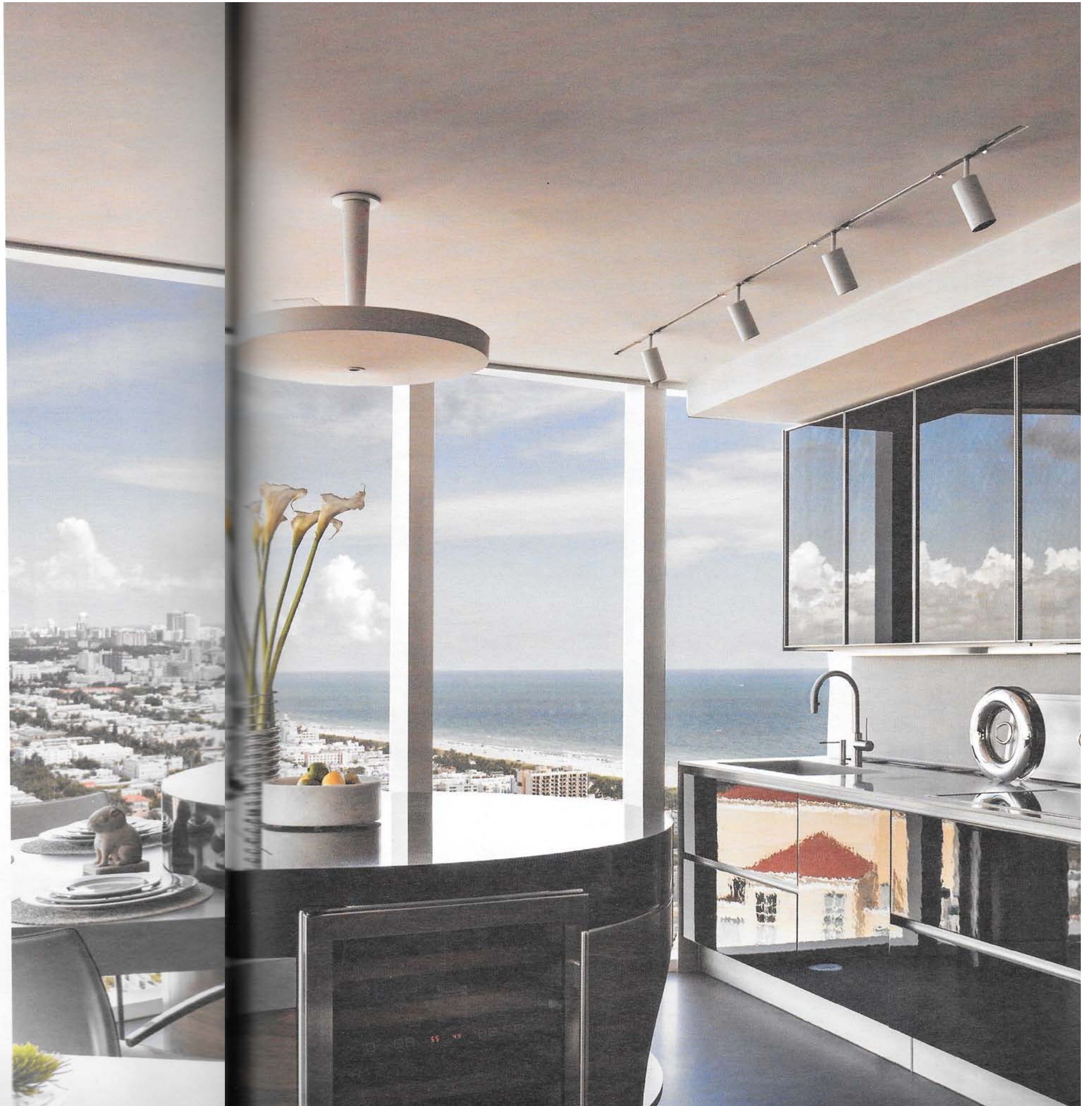



MISSION ACCOMPLISHED From left: In the foyer, Josh Chalom's "Falling Apart" depicts a man disintegrating in anxiety; in contrast, interior designer David De La Garza relaxes against the modern staircase he created from wood, stainless steel and glass.

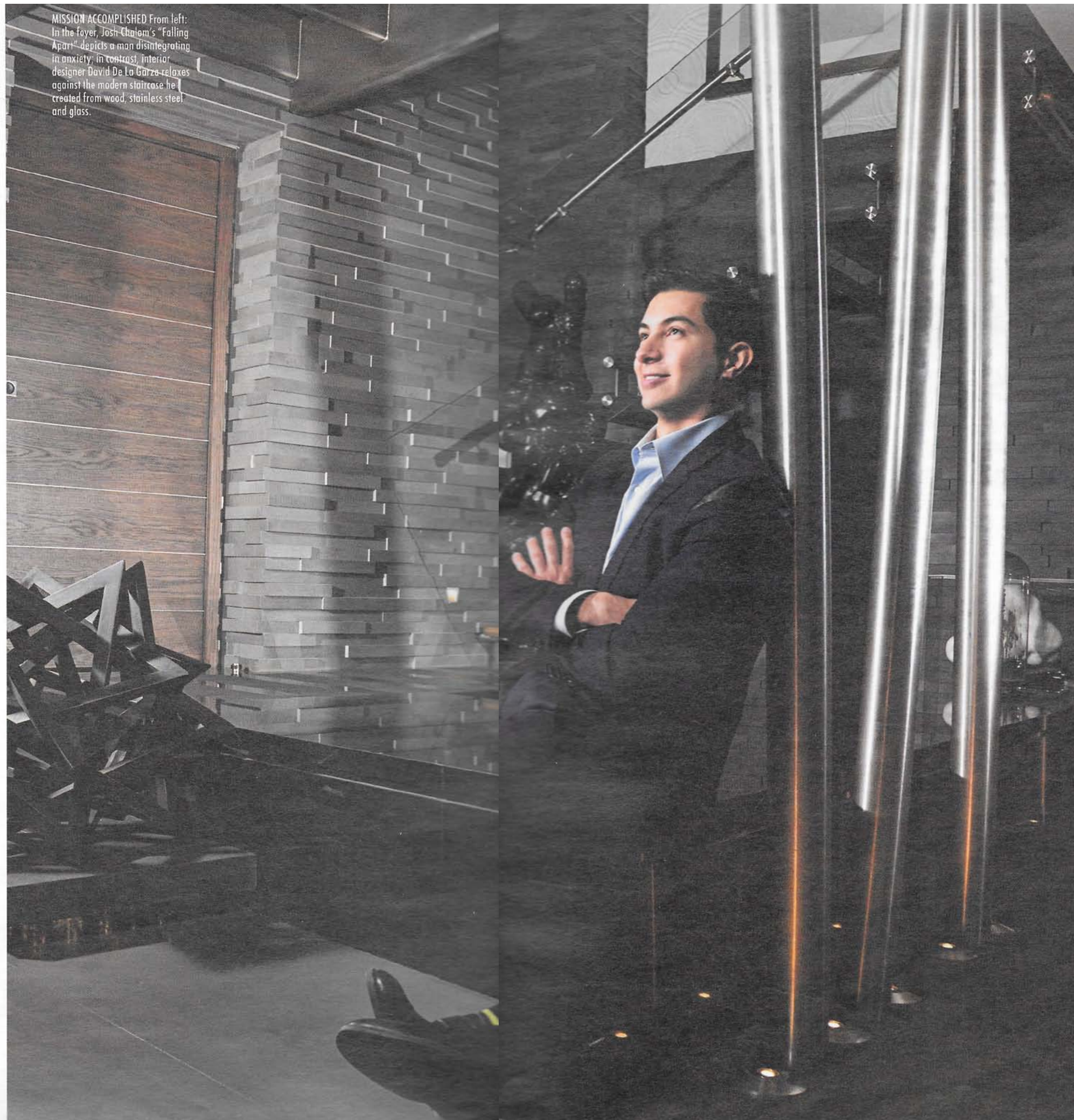

La Garza utilized wood, stainless steel and a glass rail to achieve the staircase's modern statement, and he even added the flourish of a glass bridge. "The original staircases were all concrete—horrible," the designer recalls. "I wanted to go with oak because the flooring in all the bedrooms are oak. I just wanted everything to blend."

Surprisingly, the staircase was completed in just four weeks. The penthouse's other beautiful staircase—it leads to the rooftop—is a spiral and was intended to recall the passage to the top deck of a luxury cruise ship. "Those were the *Titanic* stairs," he jokes.

The master bedroom also refers to the seductions of modern transportation. Over the Minotti bed, on the zebrawood bed wall, hangs a reflective object that at first looks like a curved mirror but is in fact a piece of the fuselage of a DC-9. "My original idea was to use almost half a wing," De La Garza explains. "But the wing was very long, and I couldn't get it inside the elevator." But De La Garza is satisfied with the fuselage and notes its historical importance: "Last year was the last time a DC-9 was in the air," he says, referring to the world's final DC-9 flight—a Delta aircraft—in early 2014.

If the client's desire was to achieve and pay tribute to movement and dynamism, De La Garza's mission was accomplished. "When you're standing in the master bedroom, you can see the boats, the huge cruise ships, the cars on the MacArthur Causeway, and you can see the planes," he observes. "The official flight path for the Miami airport goes right around the building. The client wanted to enjoy all these

DESIGN DETAILS

TYPE
High-rise penthouse

LOCATION
South Beach

INTERIOR DESIGN
Zurdo DGS
zurdodgs.com

LIGHTING DESIGN
Lux Populi
luxpopuli.com

RESOURCES
ABC Carpet & Home
Living room silk rug
abchome.com

Baker
Master bedroom Tic Tac drink table
bakerfurniture.com

Flexform
Living room gray leather sofas
and armchairs
flexform.it

Kettal
Outdoor furniture
kettal.com

Kravel
Living room window treatments
kravel.com

Minotti
Master bed
minotti.com

Ornare
Kitchen cabinetry
ornaremiami.com

Zurdo DGS
Custom-made wood, steel and glass
staircase; custom-made circular stairs
to rooftop; custom-made granite, oak
and corian kitchen island; custom-
made zebrawood bed wall
zurdodgs.com